

مركز البراغي والعدد
BTCO
BOLTS & TOOLS CENTER

polar
handtools

New



3/8" - 1/2" - 3/4" - 1" AND 1 1/2"

IMPACT SOCKETS

SOCKETS, BIT SOCKETS, TORSION BARS, EXTENSIONS, ADAPTORS,
UNIVERSAL JOINTS AND MORE



POLAR® IMPACT SOCKETS AND ACCESSORIES

3/8" IMPACT SOCKETS AND ACCESSORIES

6038 3/8" 6-POINT METRIC IMPACT SOCKETS

ISO 2725-2, DIN 3129

- Surface: Phosphatised finish. Material: Chrome-molybdenum steel.

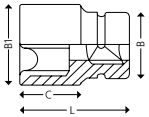

| ITEM NO. | 5704196+ | SIZE MM | B MM | B1 MM | C MM | L MM | G | |
|-----------|----------|------------|---------|----------|---------|---------|----|---|
| 6038-0006 | 023267 | 6 | 19 | 11,0 | 10 | 32 | 34 | 1 |
| 6038-0007 | 023274 | 7 | 19 | 12,5 | 12 | 32 | 34 | 1 |
| 6038-0008 | 023281 | 8 | 19 | 13,5 | 12 | 32 | 34 | 1 |
| 6038-0009 | 023298 | 9 | 19 | 14,5 | 12 | 32 | 36 | 1 |
| 6038-0010 | 023304 | 10 | 19 | 15,8 | 12 | 32 | 36 | 1 |
| 6038-0011 | 023311 | 11 | 19 | 17,0 | 12 | 32 | 36 | 1 |
| 6038-0012 | 023328 | 12 | 19 | 18,0 | 12 | 32 | 38 | 1 |
| 6038-0013 | 023335 | 13 | 22 | 19,5 | 12 | 32 | 52 | 1 |
| 6038-0014 | 023342 | 14 | 22 | 20,8 | 12 | 32 | 54 | 1 |
| 6038-0015 | 023359 | 15 | 22 | 22,0 | 10 | 32 | 57 | 1 |
| 6038-0016 | 023366 | 16 | 22 | 23,8 | 11 | 32 | 62 | 1 |
| 6038-0017 | 023373 | 17 | 22 | 25,0 | 11 | 32 | 60 | 1 |
| 6038-0018 | 023380 | 18 | 22 | 26,0 | 10 | 32 | 64 | 1 |
| 6038-0019 | 023397 | 19 | 22 | 27,8 | 10 | 32 | 73 | 1 |
| 6038-0020 | 023403 | 20 | 22 | 30,0 | 17 | 32 | 73 | 1 |
| 6038-0021 | 023410 | 21 | 22 | 30,0 | 17 | 32 | 68 | 1 |
| 6038-0022 | 023427 | 22 | 22 | 32,0 | 15 | 32 | 84 | 1 |
| 6038-0024 | 023434 | 24 | 22 | 34,0 | 16 | 32 | 74 | 1 |

6238 EX 3/8" EXTENSIONS

- Surface: Phosphatised finish. Material: Chrome-molybdenum steel.

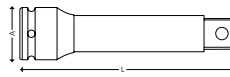

| ITEM NO. | 5704196+ | L MM | A MM | G | |
|-----------|----------|---------|---------|-----|---|
| 6238-0075 | 023625 | 75 | 19 | 85 | 1 |
| 6238-0125 | 023632 | 125 | 19 | 123 | 1 |

6614 A 1/4" ADAPTER FROM 1/4" TO 3/8"

- Surface: Phosphatised finish. Material: Chrome-molybdenum steel.

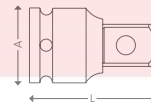

| ITEM NO. | 5704196+ | A MM | L MM | G | |
|-----------|----------|---------|---------|----|---|
| 6614-1438 | 023595 | 14 | 26 | 18 | 1 |

6712 A 1/2" ADAPTER FROM 1/2" TO 3/8"

- Surface: Phosphatised finish. Material: Chrome-molybdenum steel.

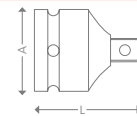

| ITEM NO. | 5704196+ | A MM | L MM | G | |
|-----------|----------|---------|---------|----|---|
| 6712-1238 | 023601 | 25 | 38 | 60 | 1 |

6138 TW 3/8" METRIC IMPACT SOCKETS

ISO 1174, DIN 3120

- Twist sockets for removal rounded or damaged fasteners with almost any head configuration.
- Surface: Phosphatised finish.
- Material: Chrome-molybdenum steel.

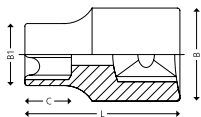

| ITEM NO. | 5704196+ | SIZE MM | B1 MM | L MM | G | |
|-----------|----------|------------|----------|---------|----|---|
| 6138-5011 | 025605 | 11 | 16,0 | 32 | 34 | 1 |
| 6138-5012 | 025612 | 12 | 18,0 | 32 | 36 | 1 |
| 6138-5013 | 025629 | 13 | 18,5 | 32 | 57 | 1 |
| 6138-5014 | 025636 | 14 | 20,5 | 32 | 57 | 1 |
| 6138-5015 | 025643 | 15 | 22,0 | 32 | 57 | 1 |
| 6138-5016 | 025650 | 16 | 22,5 | 32 | 58 | 1 |
| 6138-5017 | 025667 | 17 | 24,5 | 32 | 77 | 1 |
| 6138-5019 | 025674 | 19 | 27,0 | 32 | 93 | 1 |

6838 U 3/8" UNIVERSAL JOINT

- Surface: Phosphatised finish. Material: Chrome-molybdenum steel.

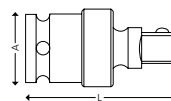

| ITEM NO. | 5704196+ | L MM | A MM | G | |
|-----------|----------|---------|---------|-----|---|
| 6838-0038 | 023618 | 53 | 27 | 105 | 1 |



POLAR® IMPACT SOCKETS AND ACCESSORIES



1/2" IMPACT SOCKETS AND ACCESSORIES

6012 1/2" 6-POINT METRIC IMPACT SOCKETS

ISO 2725-2, DIN 3129

- Surface: Phosphatised finish. Material: Chrome-molybdenum steel.

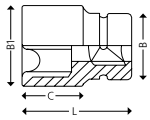

| ITEM NO. | 5704196+ | SIZE MM | B MM | B1 MM | C MM | L MM | G | |
|-----------|----------|---------|------|-------|------|------|-----|---|
| 6012-0008 | 023441 | 8 | 24 | 14,0 | 15 | 38 | 55 | 1 |
| 6012-0009 | 023458 | 9 | 24 | 16,0 | 14 | 38 | 60 | 1 |
| 6012-0010 | 016054 | 10 | 25 | 17,5 | 12 | 39 | 70 | 1 |
| 6012-0011 | 016061 | 11 | 25 | 18,5 | 12 | 39 | 71 | 1 |
| 6012-0012 | 016078 | 12 | 25 | 20,0 | 12 | 39 | 72 | 1 |
| 6012-0013 | 016085 | 13 | 25 | 21,0 | 12 | 39 | 74 | 1 |
| 6012-0014 | 016092 | 14 | 25 | 22,5 | 12 | 39 | 79 | 1 |
| 6012-0015 | 016108 | 15 | 30 | 25,0 | 12 | 39 | 119 | 1 |
| 6012-0016 | 016115 | 16 | 30 | 26,0 | 12 | 39 | 121 | 1 |
| 6012-0017 | 016122 | 17 | 30 | 26,0 | 13 | 39 | 122 | 1 |
| 6012-0018 | 016139 | 18 | 30 | 27,5 | 13 | 39 | 123 | 1 |
| 6012-0019 | 016146 | 19 | 30 | 28,0 | 13 | 39 | 125 | 1 |
| 6012-0020 | 023465 | 20 | 30 | 30,0 | 15 | 38 | 120 | 1 |
| 6012-0021 | 016153 | 21 | 30 | 30,0 | 13 | 39 | 127 | 1 |
| 6012-0022 | 016160 | 22 | 30 | 32,0 | 13 | 39 | 131 | 1 |
| 6012-0023 | 023472 | 23 | 30 | 32,0 | 14 | 38 | 123 | 1 |
| 6012-0024 | 016177 | 24 | 30 | 34,0 | 20 | 39 | 175 | 1 |
| 6012-0025 | 023489 | 25 | 30 | 36,0 | 16 | 43 | 167 | 1 |
| 6012-0026 | 023496 | 26 | 30 | 36,0 | 21 | 43 | 148 | 1 |
| 6012-0027 | 016184 | 27 | 30 | 38,0 | 24 | 43 | 225 | 1 |
| 6012-0028 | 023502 | 28 | 30 | 40,0 | 22 | 47 | 200 | 1 |
| 6012-0029 | 023519 | 29 | 30 | 40,0 | 22 | 47 | 195 | 1 |
| 6012-0030 | 016191 | 30 | 30 | 42,0 | 24 | 48 | 253 | 1 |
| 6012-0032 | 016207 | 32 | 30 | 44,0 | 26 | 48 | 273 | 1 |
| 6012-0036 | 023526 | 36 | 43 | 50,0 | 25 | 47 | 362 | 1 |

6012 L 1/2" 6-POINT LONG METRIC IMPACT SOCKETS

- Surface: Phosphatised finish. Material: Chrome-molybdenum steel.

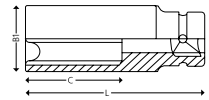

| ITEM NO. | 5704196+ | SIZE MM | B MM | B1 MM | C MM | L MM | G | |
|-----------|----------|---------|------|-------|------|------|-----|---|
| 6012-4010 | 016214 | 10 | 24 | 17,5 | 14 | 78 | 154 | 1 |
| 6012-4011 | 016221 | 11 | 24 | 18,5 | 14 | 78 | 163 | 1 |
| 6012-4012 | 016238 | 12 | 24 | 20,0 | 14 | 78 | 169 | 1 |
| 6012-4013 | 016245 | 13 | 24 | 21,0 | 14 | 78 | 185 | 1 |
| 6012-4014 | 016252 | 14 | 24 | 22,0 | 17 | 78 | 201 | 1 |
| 6012-4015 | 016269 | 15 | 24 | 24,0 | 17 | 78 | 213 | 1 |
| 6012-4016 | 016276 | 16 | 24 | 24,0 | 17 | 78 | 224 | 1 |
| 6012-4017 | 016283 | 17 | 26 | 26,0 | 17 | 78 | 252 | 1 |
| 6012-4018 | 016290 | 18 | 28 | 28,0 | 17 | 78 | 283 | 1 |
| 6012-4019 | 016306 | 19 | 28 | 28,0 | 19 | 78 | 268 | 1 |
| 6012-4020 | 023533 | 20 | 30 | 30,0 | 24 | 78 | 247 | 1 |
| 6012-4021 | 016313 | 21 | 30 | 30,0 | 24 | 78 | 310 | 1 |
| 6012-4022 | 016320 | 22 | 30 | 32,0 | 24 | 78 | 302 | 1 |
| 6012-4023 | 023540 | 23 | 30 | 32,0 | 26 | 78 | 256 | 1 |
| 6012-4024 | 016337 | 24 | 30 | 34,0 | 24 | 78 | 309 | 1 |
| 6012-4025 | 023557 | 25 | 30 | 36,0 | 35 | 78 | 296 | 1 |
| 6012-4026 | 023564 | 26 | 30 | 36,0 | 35 | 78 | 280 | 1 |
| 6012-4027 | 016344 | 27 | 30 | 38,0 | 24 | 78 | 325 | 1 |
| 6012-4028 | 023571 | 28 | 30 | 40,0 | 35 | 78 | 316 | 1 |
| 6012-4029 | 023588 | 29 | 30 | 40,0 | 35 | 78 | 355 | 1 |
| 6012-4030 | 016351 | 30 | 30 | 42,0 | 24 | 78 | 352 | 1 |
| 6012-4032 | 016368 | 32 | 30 | 44,0 | 24 | 78 | 317 | 1 |

6090 1/2" METRIC SOCKET WRENCH SET

ITEM NO. 6090-1222

- Set in watertight plastic case with 6-point impact sockets from 10 to 32 mm and accessories.
- 22 tools.

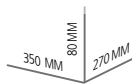

3,5 KG

5704196 016474

1



CONTENT:

| QTY. | DESCRIPTION | SIZE |
|------|-----------------|---|
| 15 | 6-point sockets | 6012 1/2" 10 - 11 - 12 - 13 - 14 - 15 - 16 - 17 - 19 - 21 - 22 - 24 - 27 - 30 - 32 mm |
| 1 | Extension | 6212 1/2" EX 125 mm |
| 1 | Adaptor | 6638 1/2" A |
| 2 | Safety set | 6012 1/2" SR 8 - 14 mm / 15 - 32 mm |





POLAR® IMPACT SOCKETS AND ACCESSORIES

6090 L 1/2" METRIC SOCKET WRENCH SET

ITEM NO. 6090-1220

- Set in watertight plastic case with 6-point long impact sockets from 10 to 32 mm and accessories.
- 20 tools.

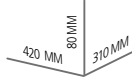

4,6 KG

5704196 016481

1

20
TOOLS

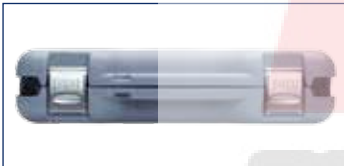

CONTENT:

| QTY. | DESCRIPTION | SIZE |
|------|----------------------|---|
| 15 | Long 6-point sockets | 6012 1/2" L 10 - 11 - 12 - 13 - 14 - 15 - 16 - 17 - 19 - 21 - 22 - 24 - 27 - 30 - 32 mm |
| 1 | Extension | 6212 1/2" EX 125 mm |
| 2 | Safety set | 6012 1/2" SR 8 - 14 mm / 15 - 32 mm |

6090 LT 1/2" METRIC SOCKET WRENCH SET

ITEM NO. 6090-1204

- Set in metal box with 6-point long impact sockets with thin walls for wheel nuts.
- 6 tools.

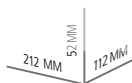

1,5 KG

5704196 016467

1

6
TOOLS



CONTENT:

| QTY. | DESCRIPTION | SIZE |
|------|---------------------------------|-----------------------------------|
| 4 | Long thinwalled 6-point sockets | 6012 1/2" LT 17 - 19 - 21 - 22 mm |
| 1 | Safety set | 6012 1/2" SR 15 - 32 mm |

POLAR® IMPACT SOCKETS AND ACCESSORIES



6012 LT 1/2" 6-POINT LONG METRIC IMPACT SOCKETS

- Model with thin walls for wheel nuts.
- Surface: Phosphatised finish. Material: Chrome-molybdenum steel.

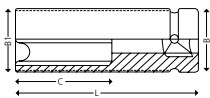

| ITEM NO. | 5704196+ | SIZE MM | B MM | B1 MM | C MM | L MM | G G | |
|-----------|----------|------------|---------|----------|---------|---------|--------|---|
| 6012-4115 | 023649 | 15 | 28 | 27,0 | 24 | 85 | 185 | 1 |
| 6012-4117 | 016375 | 17 | 30 | 24,0 | 24 | 85 | 240 | 1 |
| 6012-4119 | 016382 | 19 | 30 | 26,0 | 24 | 85 | 259 | 1 |
| 6012-4121 | 016399 | 21 | 30 | 28,0 | 24 | 85 | 270 | 1 |
| 6012-4122 | 016405 | 22 | 30 | 29,5 | 24 | 85 | 296 | 1 |
| 6012-4124 | 023656 | 24 | 33 | 31,0 | 24 | 85 | 303 | 1 |
| 6012-4127 | 023663 | 27 | 37 | 35,0 | 28 | 85 | 406 | 1 |

6112 TW 1/2" METRIC IMPACT SOCKETS

ISO 1174, DIN 3120

- Twist sockets for removal rounded or damaged fasteners with almost any head configuration.
- Surface: Phosphatised finish. Material: Chrome-molybdenum steel.

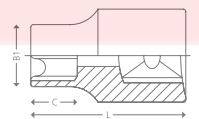

| ITEM NO. | 5704196+ | SIZE MM | B1 MM | L MM | G G | |
|-----------|----------|------------|----------|---------|--------|---|
| 6112-5010 | 025476 | 10 | 16,0 | 34 | 43 | 1 |
| 6112-5011 | 025483 | 11 | 18,0 | 34 | 47 | 1 |
| 6112-5012 | 025490 | 12 | 18,5 | 34 | 49 | 1 |
| 6112-5013 | 025506 | 13 | 20,5 | 34 | 53 | 1 |
| 6112-5014 | 025513 | 14 | 22,0 | 34 | 70 | 1 |
| 6112-5015 | 025520 | 15 | 22,4 | 34 | 70 | 1 |
| 6112-5016 | 025537 | 16 | 23,5 | 34 | 71 | 1 |
| 6112-5017 | 025544 | 17 | 25,5 | 34 | 81 | 1 |
| 6112-5018 | 025551 | 18 | 26,5 | 34 | 91 | 1 |
| 6112-5019 | 025568 | 19 | 27,5 | 34 | 93 | 1 |
| 6112-5021 | 025575 | 21 | 29,5 | 34 | 94 | 1 |
| 6112-5024 | 025582 | 24 | 33,0 | 34 | 112 | 1 |
| 6112-5027 | 025599 | 27 | 37,0 | 34 | 116 | 1 |

6112 M 1/2" IMPACT TORSION BARS

ISO 1174, DIN 3120

- Surface: Phosphatised finish. Material: Chrome-molybdenum steel.



| ITEM NO. | 5704196+ | MAX. Nm | C MM | L MM | G G | |
|-----------|----------|------------|---------|---------|--------|---|
| 6112-6090 | 025681 | 90 | 25 | 200 | 172 | 1 |
| 6112-6100 | 025698 | 100 | 25 | 200 | 215 | 1 |
| 6112-6120 | 025704 | 120 | 25 | 200 | 200 | 1 |
| 6112-6135 | 025711 | 135 | 25 | 200 | 214 | 1 |
| 6112-6150 | 025728 | 150 | 25 | 200 | 259 | 1 |



POLAR® IMPACT SOCKETS AND ACCESSORIES

6112 H 1/2" IMPACT SOCKET DRIVERS, HEX HEAD SCREWS

■ Surface: Phosphatised finish. Material: Chrome-molybdenum steel.



| ITEM NO. | 5704196+ | SIZE MM | C MM | L MM | G | |
|-----------|----------|---------|------|------|-----|---|
| 6112-2005 | 023670 | 5 | 25 | 78 | 96 | 1 |
| 6112-2006 | 023687 | 6 | 25 | 78 | 97 | 1 |
| 6112-2008 | 023694 | 8 | 25 | 78 | 102 | 1 |
| 6112-2010 | 023700 | 10 | 25 | 78 | 108 | 1 |
| 6112-2012 | 023717 | 12 | 25 | 78 | 125 | 1 |
| 6112-2014 | 023724 | 14 | 25 | 78 | 145 | 1 |
| 6112-2017 | 023731 | 17 | 25 | 78 | 182 | 1 |
| 6112-2019 | 023748 | 19 | 25 | 78 | 210 | 1 |

6212 EX 1/2" EXTENSIONS

■ Surface: Phosphatised finish. Material: Chrome-molybdenum steel.



| ITEM NO. | 5704196+ | L MM | A MM | G | |
|-----------|----------|------|------|-----|---|
| 6212-0075 | 016443 | 75 | 24 | 138 | 1 |
| 6212-0125 | 016450 | 125 | 24 | 215 | 1 |

6734 A 3/4" ADAPTOR FROM 3/4" TO 1/2"

■ Surface: Phosphatised finish. Material: Chrome-molybdenum steel.



| ITEM NO. | 5704196+ | 3/4" | 1/2" | A MM | L MM | G | |
|-----------|----------|------|------|------|------|-----|---|
| 6734-3412 | 016412 | | | 44 | 56 | 305 | 1 |

6112 TX 1/2" IMPACT SOCKET DRIVERS, TORX® SCREWS

■ Surface: Phosphatised finish. Material: Chrome-molybdenum steel.

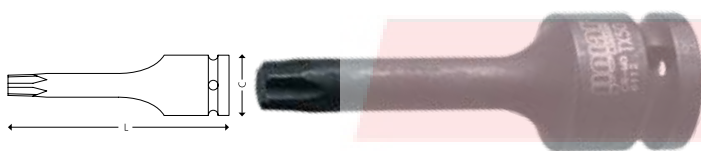

| ITEM NO. | 5704196+ | TORX® NO. | MM | C MM | L MM | G | |
|-----------|----------|-----------|-------|------|------|-----|---|
| 6112-1030 | 023755 | T30 | 5,52 | 25 | 78 | 77 | 1 |
| 6112-1040 | 023762 | T40 | 6,65 | 25 | 78 | 81 | 1 |
| 6112-1045 | 023779 | T45 | 7,82 | 25 | 78 | 85 | 1 |
| 6112-1050 | 023786 | T50 | 8,83 | 25 | 78 | 89 | 1 |
| 6112-1055 | 023793 | T55 | 11,22 | 25 | 78 | 107 | 1 |
| 6112-1060 | 023809 | T60 | 13,25 | 25 | 78 | 119 | 1 |

6638 A 3/8" ADAPTOR FROM 3/8" TO 1/2"

■ Surface: Phosphatised finish. Material: Chrome-molybdenum steel.



| ITEM NO. | 5704196+ | 3/8" | 1/2" | A MM | L MM | G | |
|-----------|----------|------|------|------|------|----|---|
| 6638-3812 | 016429 | | | 22 | 38 | 64 | 1 |

6112 X 1/2" IMPACT SOCKET DRIVERS, XZN® SCREWS

■ Surface: Phosphatised finish. Material: Chrome-molybdenum steel.



| ITEM NO. | 5704196+ | SIZE MM | C MM | L MM | G | |
|-----------|----------|---------|------|------|-----|---|
| 6112-4005 | 023816 | M5 | 25 | 78 | 79 | 1 |
| 6112-4006 | 023823 | M6 | 25 | 78 | 83 | 1 |
| 6112-4008 | 023830 | M8 | 25 | 78 | 84 | 1 |
| 6112-4010 | 023847 | M10 | 25 | 78 | 100 | 1 |
| 6112-4012 | 023854 | M10 | 25 | 78 | 105 | 1 |
| 6112-4014 | 023861 | M14 | 25 | 78 | 117 | 1 |
| 6112-4016 | 023878 | M16 | 25 | 78 | 136 | 1 |

6812 U 1/2" UNIVERSAL JOINT

■ Surface: Phosphatised finish. Material: Chrome-molybdenum steel.



| ITEM NO. | 5704196+ | L MM | A MM | G | |
|-----------|----------|------|------|-----|---|
| 6812-0012 | 016436 | 65 | 28 | 205 | 1 |



POLAR® IMPACT SOCKETS AND ACCESSORIES



3/4" IMPACT SOCKETS AND ACCESSORIES

6034 3/4" 6-POINT METRIC IMPACT SOCKETS

ISO 2725-2, DIN 3129

- Surface: Phosphatised finish. Material: Chrome-molybdenum steel.

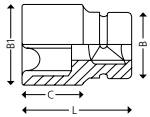

| ITEM NO. | 5704196+ | SIZE MM | B MM | B1 MM | C MM | L MM | G | |
|-----------|----------|------------|---------|----------|---------|---------|------|---|
| 6034-0017 | 023885 | 17 | 38 | 30,0 | 17 | 51 | 230 | 1 |
| 6034-0019 | 023908 | 19 | 38 | 32,0 | 18 | 52 | 240 | 1 |
| 6034-0021 | 023922 | 21 | 38 | 35,0 | 18 | 52 | 258 | 1 |
| 6034-0022 | 023939 | 22 | 38 | 35,0 | 18 | 52 | 258 | 1 |
| 6034-0024 | 023953 | 24 | 38 | 38,0 | 18 | 52 | 273 | 1 |
| 6034-0027 | 023984 | 27 | 40 | 40,0 | 28 | 52 | 283 | 1 |
| 6034-0028 | 023991 | 28 | 40 | 40,0 | 28 | 52 | 271 | 1 |
| 6034-0030 | 024004 | 30 | 44 | 44,0 | 28 | 52 | 360 | 1 |
| 6034-0032 | 024011 | 32 | 44 | 48,0 | 31 | 56 | 443 | 1 |
| 6034-0033 | 024028 | 33 | 44 | 48,0 | 32 | 56 | 420 | 1 |
| 6034-0034 | 024035 | 34 | 44 | 52,0 | 29 | 56 | 490 | 1 |
| 6034-0036 | 024042 | 36 | 44 | 52,0 | 32 | 56 | 465 | 1 |
| 6034-0038 | 024059 | 38 | 44 | 56,0 | 32 | 56 | 530 | 1 |
| 6034-0041 | 024066 | 41 | 44 | 60,0 | 28 | 56 | 575 | 1 |
| 6034-0046 | 024073 | 46 | 44 | 67,0 | 28 | 61 | 720 | 1 |
| 6034-0050 | 024080 | 50 | 54 | 71,0 | 42 | 72 | 1050 | 1 |
| 6034-0055 | 024097 | 55 | 54 | 77,0 | 40 | 74 | 1220 | 1 |
| 6034-0060 | 024103 | 60 | 54 | 84,0 | 40 | 74 | 1385 | 1 |

6034 LT 3/4" 6-POINT LONG METRIC IMPACT SOCKETS

- Model with thin walls for wheel nuts.
- Surface: Phosphatised finish. Material: Chrome-molybdenum steel.

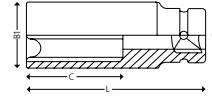

| ITEM NO. | 5704196+ | SIZE MM | B MM | B1 MM | C MM | L MM | G | |
|-----------|----------|------------|---------|----------|---------|---------|-----|---|
| 6034-4119 | 024240 | 19 | 44 | 29,0 | 41 | 90 | 550 | 1 |
| 6034-4122 | 024257 | 22 | 44 | 34,0 | 35 | 90 | 585 | 1 |
| 6034-4124 | 024264 | 24 | 44 | 37,0 | 37 | 90 | 620 | 1 |
| 6034-4127 | 024271 | 27 | 44 | 41,0 | 60 | 90 | 575 | 1 |
| 6034-4130 | 024288 | 30 | 44 | 44,0 | 56 | 90 | 575 | 1 |
| 6034-4132 | 024295 | 32 | 44 | 47,0 | 56 | 90 | 635 | 1 |
| 6034-4133 | 024301 | 33 | 44 | 48,0 | 56 | 90 | 655 | 1 |
| 6034-4136 | 024318 | 36 | 44 | 52,0 | 53 | 90 | 735 | 1 |

6234 EX 3/4" EXTENSIONS

- Surface: Phosphatised finish. Material: Chrome-molybdenum steel.



| ITEM NO. | 5704196+ | L MM | A MM | G | |
|-----------|----------|---------|---------|------|---|
| 6234-0100 | 024196 | 100 | 44 | 560 | 1 |
| 6234-0250 | 024202 | 250 | 44 | 1110 | 1 |

6034 L 3/4" 6-POINT LONG METRIC IMPACT SOCKETS

- Surface: Phosphatised finish. Material: Chrome-molybdenum steel.

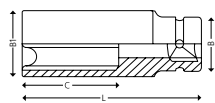

| ITEM NO. | 5704196+ | SIZE MM | B MM | B1 MM | C MM | L MM | G | |
|-----------|----------|------------|---------|----------|---------|---------|-----|---|
| 6034-4022 | 024110 | 22 | 44 | 37,0 | 32 | 90 | 640 | 1 |
| 6034-4024 | 024127 | 24 | 44 | 39,0 | 36 | 90 | 655 | 1 |
| 6034-4027 | 024134 | 27 | 44 | 43,0 | 57 | 90 | 615 | 1 |
| 6034-4030 | 024141 | 30 | 44 | 46,0 | 57 | 90 | 665 | 1 |
| 6034-4032 | 024158 | 32 | 44 | 49,0 | 57 | 90 | 720 | 1 |
| 6034-4033 | 024165 | 33 | 44 | 51,0 | 57 | 90 | 760 | 1 |
| 6034-4036 | 024172 | 36 | 44 | 54,0 | 57 | 90 | 830 | 1 |
| 6034-4041 | 024189 | 41 | 44 | 60,0 | 57 | 92 | 935 | 1 |

6612 A 1/2" ADAPTER FROM 1/2" TO 3/4"

- Surface: Phosphatised finish. Material: Chrome-molybdenum steel.

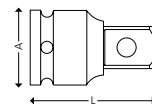

| ITEM NO. | 5704196+ | □ | ■ | A MM | L MM | G | |
|-----------|----------|------|------|---------|---------|-----|---|
| 6612-1234 | 024219 | 1/2" | 3/4" | 30 | 48 | 165 | 1 |

6701 A 1" ADAPTER FROM 1" TO 3/4"

- Surface: Phosphatised finish. Material: Chrome-molybdenum steel.

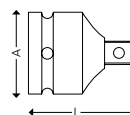

| ITEM NO. | 5704196+ | □ | ■ | A MM | L MM | G | |
|-----------|----------|----|------|---------|---------|-----|---|
| 6701-0134 | 024226 | 1" | 3/4" | 54 | 72 | 610 | 1 |



POLAR® IMPACT SOCKETS AND ACCESSORIES

6834 U 3/4" UNIVERSAL JOINT

■ Surface: Phosphatised finish. Material: Chrome-molybdenum steel.

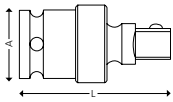

| ITEM NO. | 5704196+ | L MM | A MM | G | |
|-----------|----------|---------|---------|-----|---|
| 6834-0034 | 024233 | 90 | 44 | 650 | 1 |

6001 L 1" 6-POINT LONG METRIC IMPACT SOCKETS

■ Surface: Phosphatised finish. Material: Chrome-molybdenum steel.

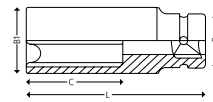

| ITEM NO. | 5704196+ | SIZE MM | B MM | B1 MM | C MM | L MM | G | |
|-----------|----------|------------|---------|----------|---------|---------|------|---|
| 6001-4024 | 024462 | 24 | 54 | 42,0 | 38 | 90 | 880 | 1 |
| 6001-4027 | 024479 | 27 | 54 | 45,0 | 40 | 90 | 905 | 1 |
| 6001-4030 | 024486 | 30 | 54 | 50,0 | 42 | 90 | 955 | 1 |
| 6001-4032 | 024493 | 32 | 54 | 52,0 | 43 | 90 | 975 | 1 |
| 6001-4033 | 024509 | 33 | 54 | 53,0 | 41 | 90 | 1000 | 1 |
| 6001-4036 | 024523 | 36 | 54 | 57,0 | 53 | 90 | 1010 | 1 |
| 6001-4041 | 024530 | 41 | 54 | 63,0 | 50 | 90 | 1170 | 1 |
| 6001-4046 | 024547 | 46 | 54 | 69,0 | 64 | 100 | 1485 | 1 |
| 6001-4050 | 024554 | 50 | 54 | 74,0 | 57 | 100 | 1645 | 1 |
| 6001-4055 | 024561 | 55 | 54 | 81,0 | 48 | 100 | 1800 | 1 |
| 6001-4060 | 024578 | 60 | 54 | 87,0 | 75 | 120 | 2450 | 1 |
| 6001-4065 | 024585 | 65 | 54 | 93,0 | 78 | 120 | 2500 | 1 |
| 6001-4070 | 024592 | 70 | 54 | 98,0 | 81 | 125 | 3050 | 1 |

1" IMPACT SOCKETS AND ACCESSORIES

6001 1" 6-POINT METRIC IMPACT SOCKETS

ISO 2725-2, DIN 3129

■ Surface: Phosphatised finish. Material: Chrome-molybdenum steel.

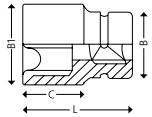

| ITEM NO. | 5704196+ | SIZE MM | B MM | B1 MM | C MM | L MM | G | |
|-----------|----------|------------|---------|----------|---------|---------|------|---|
| 6001-0024 | 024325 | 24 | 54 | 42,0 | 16 | 58 | 555 | 1 |
| 6001-0027 | 024332 | 27 | 54 | 45,0 | 16 | 58 | 575 | 1 |
| 6001-0030 | 024349 | 30 | 54 | 49,0 | 19 | 60 | 627 | 1 |
| 6001-0032 | 024356 | 32 | 54 | 52,0 | 19 | 60 | 660 | 1 |
| 6001-0033 | 024363 | 33 | 54 | 52,0 | 19 | 61 | 675 | 1 |
| 6001-0036 | 024387 | 36 | 54 | 57,0 | 27 | 65 | 740 | 1 |
| 6001-0041 | 024394 | 41 | 54 | 63,0 | 27 | 65 | 835 | 1 |
| 6001-0046 | 024400 | 46 | 54 | 69,0 | 32 | 74 | 1090 | 1 |
| 6001-0050 | 024417 | 50 | 54 | 74,0 | 32 | 74 | 1215 | 1 |
| 6001-0055 | 024424 | 55 | 54 | 80,0 | 42 | 85 | 1530 | 1 |
| 6001-0060 | 024431 | 60 | 54 | 87,0 | 46 | 90 | 1810 | 1 |
| 6001-0065 | 024448 | 65 | 54 | 93,0 | 46 | 93 | 2065 | 1 |
| 6001-0070 | 024455 | 70 | 54 | 100,0 | 52 | 98 | 2320 | 1 |

6001 LT 1" 6-POINT LONG METRIC IMPACT SOCKETS

■ Model with thin walls for wheel nuts.

■ Surface: Phosphatised finish. Material: Chrome-molybdenum steel.

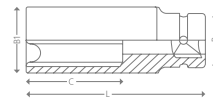

| ITEM NO. | 5704196+ | SIZE MM | B MM | B1 MM | C MM | L MM | G | |
|-----------|----------|------------|---------|----------|---------|---------|-----|---|
| 6001-4127 | 024608 | 27 | 54 | 42,0 | 42 | 90 | 830 | 1 |
| 6001-4130 | 024615 | 30 | 54 | 45,0 | 49 | 90 | 810 | 1 |
| 6001-4132 | 024622 | 32 | 54 | 47,0 | 41 | 90 | 850 | 1 |
| 6001-4133 | 024639 | 33 | 54 | 49,0 | 42 | 90 | 895 | 1 |
| 6001-4136 | 024646 | 36 | 54 | 52,0 | 52 | 90 | 820 | 1 |

6201 EX 1" EXTENSIONS

■ Surface: Phosphatised finish. Material: Chrome-molybdenum steel.

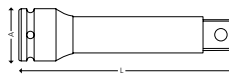

| ITEM NO. | 5704196+ | L MM | A MM | G | |
|-----------|----------|---------|---------|------|---|
| 6201-0175 | 024653 | 175 | 54 | 1410 | 1 |
| 6201-0325 | 024660 | 325 | 54 | 2400 | 1 |



POLAR® IMPACT SOCKETS AND ACCESSORIES



6634 A 3/4" ADAPTOR FROM 3/4" TO 1"

▪ Surface: Phosphatised finish. Material: Chrome-molybdenum steel.

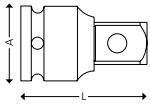

| ITEM NO. | 5704196+ | Ø | ■ | A MM | L MM | G | 📦 |
|-----------|----------|------|----|---------|---------|-----|---|
| 6634-3401 | 024677 | 3/4" | 1" | 44 | 63 | 430 | 1 |

1 1/2" IMPACT SOCKETS AND ACCESSORIES

6015 1 1/2" 6-POINT METRIC IMPACT SOCKETS

ISO 2725-2, DIN 3129

▪ Surface: Phosphatised finish. Material: Chrome-molybdenum steel.

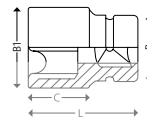

6715 A 1 1/2" ADAPTER FROM 1 1/2" TO 1"

▪ Surface: Phosphatised finish. Material: Chrome-molybdenum steel.

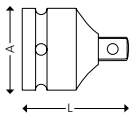

| ITEM NO. | 5704196+ | Ø | ■ | A MM | L MM | G | 📦 |
|-----------|----------|--------|----|---------|---------|------|---|
| 6715-1501 | 024684 | 1 1/2" | 1" | 86 | 100 | 1865 | 1 |

| ITEM NO. | 5704196+ | SIZE MM | B MM | B1 MM | C MM | L MM | G | 📦 |
|-----------|----------|------------|---------|----------|---------|---------|-------|---|
| 6015-0046 | 024707 | 46 | 86 | 74,0 | 29 | 84 | 2200 | 1 |
| 6015-0050 | 024714 | 50 | 86 | 79,0 | 35 | 84 | 2150 | 1 |
| 6015-0055 | 024721 | 55 | 86 | 86,0 | 35 | 90 | 2500 | 1 |
| 6015-0060 | 024738 | 60 | 86 | 92,0 | 43 | 90 | 2550 | 1 |
| 6015-0065 | 024745 | 65 | 86 | 98,0 | 45 | 95 | 2900 | 1 |
| 6015-0070 | 024752 | 70 | 86 | 104,0 | 47 | 100 | 3250 | 1 |
| 6015-0075 | 024769 | 75 | 86 | 110,0 | 48 | 110 | 4050 | 1 |
| 6015-0080 | 024776 | 80 | 86 | 116,0 | 54 | 110 | 4100 | 1 |
| 6015-0085 | 024783 | 85 | 86 | 122,0 | 54 | 110 | 4400 | 1 |
| 6015-0090 | 024790 | 90 | 86 | 130,0 | 57 | 112 | 4950 | 1 |
| 6015-0095 | 024806 | 95 | 95 | 135,0 | 62 | 112 | 5150 | 1 |
| 6015-0100 | 024813 | 100 | 95 | 140,0 | 58 | 115 | 5800 | 1 |
| 6015-0105 | 024820 | 105 | 95 | 148,0 | 65 | 120 | 6350 | 1 |
| 6015-0110 | 024837 | 110 | 95 | 154,0 | 70 | 125 | 7300 | 1 |
| 6015-0115 | 024844 | 115 | 95 | 160,0 | 65 | 130 | 7800 | 1 |
| 6015-0120 | 024851 | 120 | 127 | 165,0 | 67 | 135 | 11950 | 1 |

6801 U 1" UNIVERSAL JOINT

▪ Surface: Phosphatised finish. Material: Chrome-molybdenum steel.

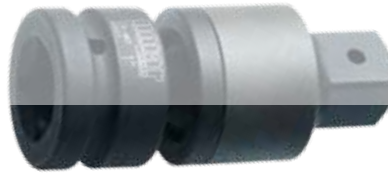
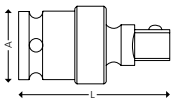

| ITEM NO. | 5704196+ | L MM | A MM | G | 📦 |
|-----------|----------|---------|---------|------|---|
| 6801-0001 | 024691 | 110 | 54 | 1320 | 1 |

6601 A 1" ADAPTER FROM 1" TO 1 1/2"

▪ Surface: Phosphatised finish. Material: Chrome-molybdenum steel.

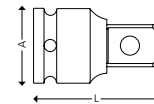

| ITEM NO. | 5704196+ | Ø | ■ | A MM | L MM | G | 📦 |
|-----------|----------|----|--------|---------|---------|------|---|
| 6601-0115 | 024868 | 1" | 1 1/2" | 54 | 90 | 1065 | 1 |

6012 SR 1/2" SAFETY SET

▪ Includes safety ring and pin.



| ITEM NO. | 5704196+ | SIZE | G | 📦 |
|-----------|----------|----------------------|---|---|
| 6012-9301 | 016498 | 6012 1/2" 8 - 14 mm | 3 | 1 |
| 6012-9302 | 016504 | 6012 1/2" 15 - 32 mm | 4 | 1 |

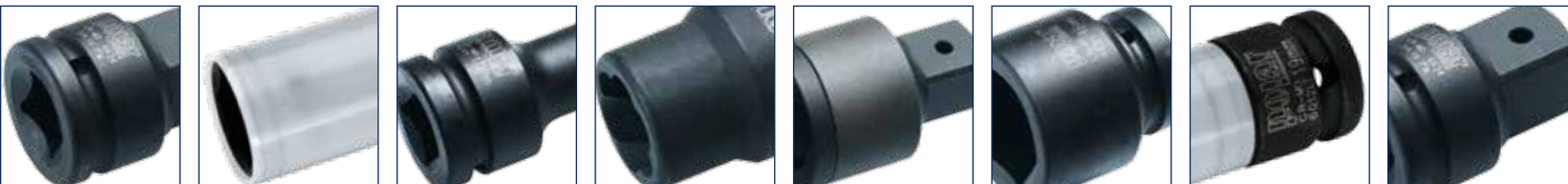

POLAR TOOLS A/S

مركز البراغي والعدد
BOLTS & TOOLS CENTER **BTGO**